

Zoning Map 44



Zoning Districts

Residential District

- R-40,000
- R-20,000
- R-10,000
- R-7,500

Commercial District

- C-1
- C-2
- C-3
- I-1
- I-2

Resource District

- Heritage
- Agriculture
- Conservation

Overlays

Mineral Resource Overlay

- MR (Recovery Area)
- VRA (Viable Resource Area)
- MRN (Notification Area)

Historic District Overlay

- Historic District Overlay

General

- County Border
- Corporate Limits
- Parcel Boundary
- Election District Boundary
- Railroad

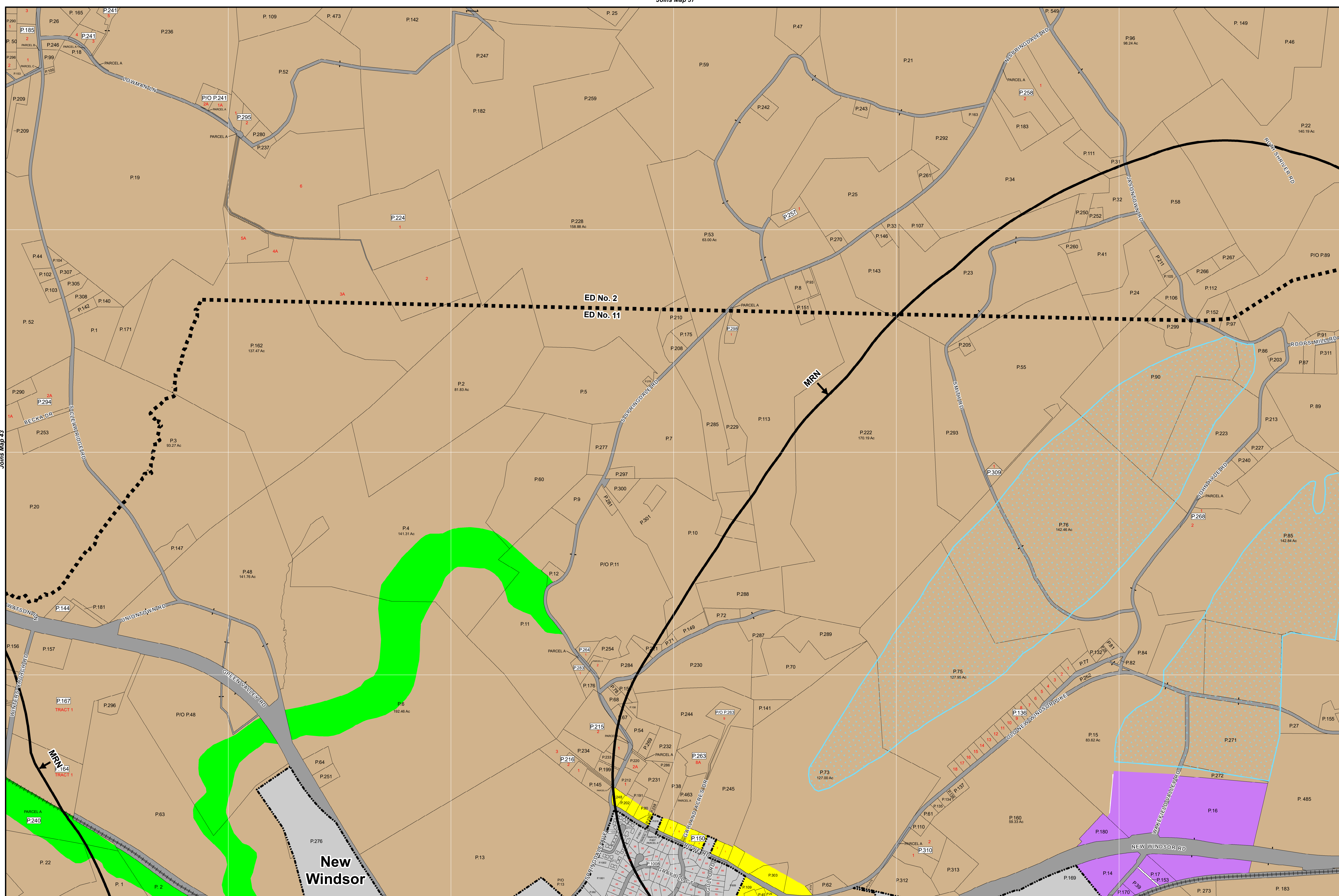
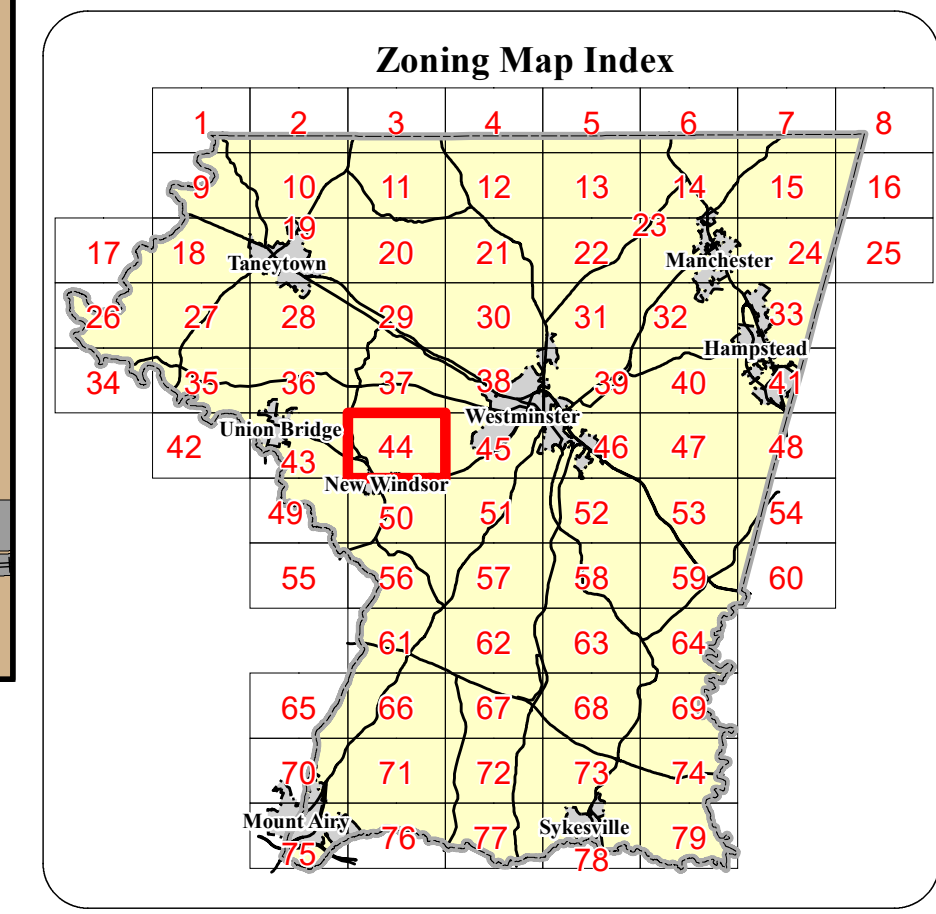
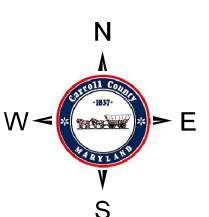

Rev. #	MA #	Date	Description	Rev. #	MA #	Date	Description
9.	MA 251	9/20/2001	Annexation - #3-2000	18.			
8.	MA 244	9/28/2000	Annexation - #1-2000	17.			
7.	MA 221	11/14/1994	Annexation #2	16.			
6.	MA 220	6/23/1994	Annexation #1	15.			
5.	MA 208	2/27/1992	Mineral Resource Overlay	14.			
4.	MA 151	4/15/1986	Annexation #4	13.			
3.	MA 110	8/25/1981	New Windsor Comprehensive Plan	12.	Ord. 19-08	12/12/2019	Comprehensive Rezoning
2.	MA 48	10/28/1971	Zoning Ordinance 1E Amendment	11.			Administrative Map Correction (Parcel 13)
1.	MA 36	11/4/1969	Annexation	10.	MA 252	9/20/2001	Annexation #2-2000

Joins Map 50

The information contained on this map is not to be construed or used as a "legal description" and is not a survey product. While Carroll County strives to provide the best data possible, it does not provide any guaranty of accuracy or completeness regarding the map information. Where uncertainty exists in regards to the zoning districts, a determination by the Zoning Administrator may be required.

Any errors or omissions should be reported to the Carroll County Department of Land and Resource Management GIS Section. Mapping contact: LRM@carrollcountymd.gov or 410-386-2949. Zoning contact: zoningadministration@carrollcountymd.gov or 410-386-2980.

By Resolution of the County Commissioners of Carroll County, Maryland, a body corporate and politic of the State of Maryland

Map signed this 12th Day of December, 2019

Attest: *Shawn D. Reese*
Shawn D. Reese County Clerk

Stephen A. Wantz President
Stephen A. Wantz
Edward C. Rothstein Vice-President

C. Eric Bouchat Commissioner
C. Eric Bouchat
Dennis E. Frazier Commissioner

C. Richard Weaver 2nd Vice President
COUNTY COMMISSIONERS OF CARROLL COUNTY, MARYLAND

Zoning Map 44